



2019

Command Center Manual

Centralized Replay Room

Pac-12 Conference
360 Third Street, 3rd Floor
San Francisco, CA 94107
www.Pac-12.com

Table of Contents

A. PURPOSE

B. LOCATION

C. ACCESS

D. PERSONNEL

E. DECISION MAKING PROCESS

F. ASSIGNMENTS AND IN-SEASON SCHEDULING

G. GAMEDAY TIMELINE

H. OFFICE ACCESS/ SECURITY BADGES

I. ADDITIONAL ITEMS

This Command Center Manual—Centralized Replay Room—provides information pertaining to the operations, roles, and responsibilities for the Pac-12's Centralized Replay Room.

A. PURPOSE / USE. The Centralized Replay Room's primary function is to ensure that the instant replay process and the application of NCAA replay rules are consistent across the Pac-12 Conference. Centralized Replay involves a collaborative process and discussion between Command Center Replay Officials in the Centralized Replay Room and Replay Officials that are on-site in stadiums. The secondary function of the Centralized Replay Room is to provide and relay information to the on-site Replay Officials and on-field Officials relative to game operation issues (e.g. weather and other delays, handling of security threats, etc.). Centralized Replay will be utilized for games in which a Pac-12 officiating AND replay crew is assigned to officiate a game at a Pac-12 facility. The use of Centralized Replay for bowl games will be coordinated with the NCAA.

B. LOCATION.

The Centralized Replay Room is located within the Command Center at the Pac-12 Conference Office in San Francisco, CA (highlighted in green below).

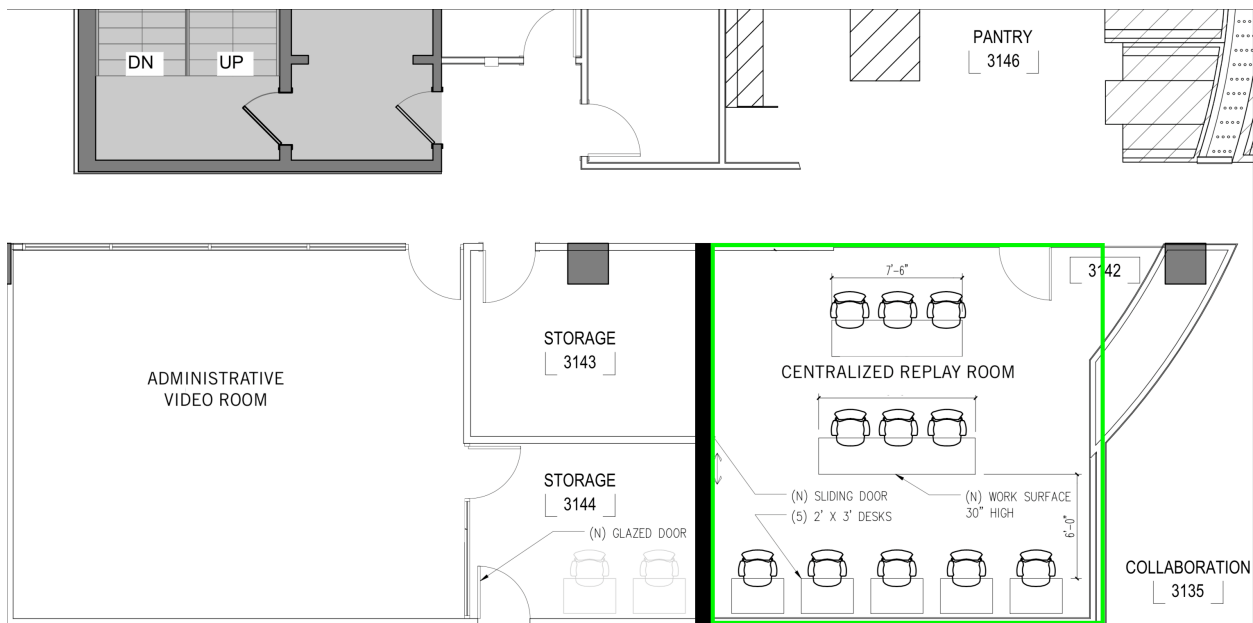

C. ACCESS. Access (whether physically present or in any of form of communication) to the Centralized Replay Room during live football games is strictly restricted to the following:

1. Pac-12 Vice President of Officiating
2. Pac-12 Supervisor of Pac-12 Instant Replay
3. Pac-12 Centralized Instant Replay Officials

4. Pac-12 Director of Video Operations
5. Pac-12 Centralized Replay Technicians
6. Pac-12 Data and Quality Control Technician / Operations Assistant

D. PERSONNEL

PAC-12 VICE PRESIDENT OF OFFICIATING. The Vice President of Officiating is responsible for the overall assessment of the Centralized Replay Room officiating operations, including the assessment of the Pac-12 Supervisor of Replay Officials and Command Center Replay Officials. The Vice President of Officiating shall NOT be involved in the Centralized Replay collaborative decision-making process; provided, however, that the Vice President of Officiating shall be allowed input into critical rules interpretation issues (e.g. determining if an untimed down is the last play of the game or if the game has ended, determining the final score, etc.).

SUPERVISOR OF REPLAY OFFICIALS: The Supervisor of Replay Officials is the Instant Replay Official that is responsible for the training, assessment and oversight of the Command Center Replay Officials and on-site stadium Instant Replay Officials. The Supervisor of Replay Officials (A) is the Pac-12's expert in the NCAA Instant Replay Rules and their application, (B) shall ensure that the Pac-12 Replay Officials are consistently applying NCAA Replay rules and interpretations as provided for in the NCAA Football Manual and NCAA Football Instant Replay Case Book, and (C) shall ensure that the Pac-12's Instant Replay decisions are consistent across crews. During live football games, the Supervisor of Replay Officials shall monitor live game video feeds and actively engage in collaborative communication with the Command Center Replay Officials and the in-stadium Replay Officials to interpret and apply NCAA football instant replay rules. The Supervisor of Replay Officials has the authority to initiate a game stoppage via communication with the in-stadium Replay Official.

COMMAND CENTER REPLAY OFFICIALS. The Command Center Replay Officials are Instant Replay Officials that are responsible for the application and interpretation of NCAA Instant Replay Rules as provided for in the NCAA Football Manual and NCAA Football Instant Replay Case Book, and ensuring that the Pac-12's Instant Replay decisions are consistent across crews. During live football games, the Command Center Replay Officials shall monitor live game video feeds and actively engage in collaborative communication with the Supervisor of Replay Officials and in-stadium Replay Officials to interpret and apply NCAA football replay rules. The Command Center Replay Officials may initiate a game stoppage via communication with the in-stadium Replay Official.

DIRECTOR OF VIDEO OPERATIONS. The Director of Video Operations is responsible for all technical operations of the Centralized Replay Room and the training and oversight of the Data Quality Control/ Operations Assistant and the Central Replay Technicians. The Director of Video Operations shall be responsible for communication with the Command Center Replay Officials and in-stadium Replay Officials regarding

technical replay equipment troubleshooting, technical issues relative to the television broadcast partner and available video, and the administration of football operations matters (e.g. weather and other delays, game start times, etc.).

COMMAND CENTER REPLAY TECHNICIAN: The Command Center Replay Technicians are responsible for the live capture of video, to mark video replays, and compile statistical data for Pac-12 football games as designated by the Supervisor of Replay Officials and the Director of Video Operations. The Command Center Replay Technicians will report to the Director of Video Operations.

DATA QUALITY CONTROL/ OPERATIONS ASSISTANT. The Data Quality Control/ Operations Assistant position will monitor and assist in the game data entered by technicians to ensure accuracy and assist the Director of Video Operations with technical and non-officiating related operations such as setup, technical troubleshooting, and game day administrative oversight. The Data Quality Control/Assistant Operations position will report to the Director of Video Operations.

E. DECISION MAKING. The Centralized Replay Room review process shall be a collaborative review process between the Supervisor of Replay Officials, the Command Center Replay Officials and the in-stadium Replay Officials. To the extent the collaborative review process does not produce an agreed-upon decision, the Supervisor of Replay Officials shall make the final decision; provided, however, that the Supervisor of Replay Officials shall make the final decision on all Targeting calls. No one except the Supervisor of Replay Officials, Centralized Replay Officials and in-stadium Replay Officials shall be involved in the collaborative review process, shall be allowed to initiate replay reviews and/or have any decision making authority; provided, however, that the Vice President of Officiating shall be allowed input into critical rules interpretation issues (e.g. determining if an untimed down is the last play of the game or if the game has ended, determining the final score, etc.).

To the extent the Supervisor of Replay Officials is unavailable to participate in the collaborative replay review process of a play(s), the decision-making authority of the Supervisor of Replay Officials shall reside with the Command Center Replay Official that has been designated by the Supervisor of Replay Officials to have such decision making authority.

To the extent there are technical difficulties that compromise the Centralized Replay Room operations or collaborative review process, final decisions and determinations shall be made by the in-stadium Replay Officials.

F. ASSIGNMENTS AND IN-SEASON SCHEDULING. The Vice President of Officiating, in communication with the Supervisor of Replay Officials, shall create the schedule and assign the Command Center Replay Officials; the Director of Video

Operations shall create the schedule and assign the Replay Technicians and Data Quality Control/Assistant Operations.

G. GAMEDAY TIMELINE FOR ALL PERSONNEL. All working personnel are required to report to the Centralized Replay Room at least 30 minutes prior to kickoff of the game they are working.

H. OFFICE ACCESS/ SECURITY BADGES. All working personnel will receive a security badge for 360 3rd Street Building and Conference Office access. Access within the Conference Office shall be limited to the Centralized Replay Room, Shield Kitchen (Pantry), the Administrative Video Room, and Restrooms (see diagram and highlighted in green). At no time should anyone enter employee offices, workspaces, or common areas beyond those outlined. All working personnel must return their security badge to the Director of Video Operations at the end of each football season.

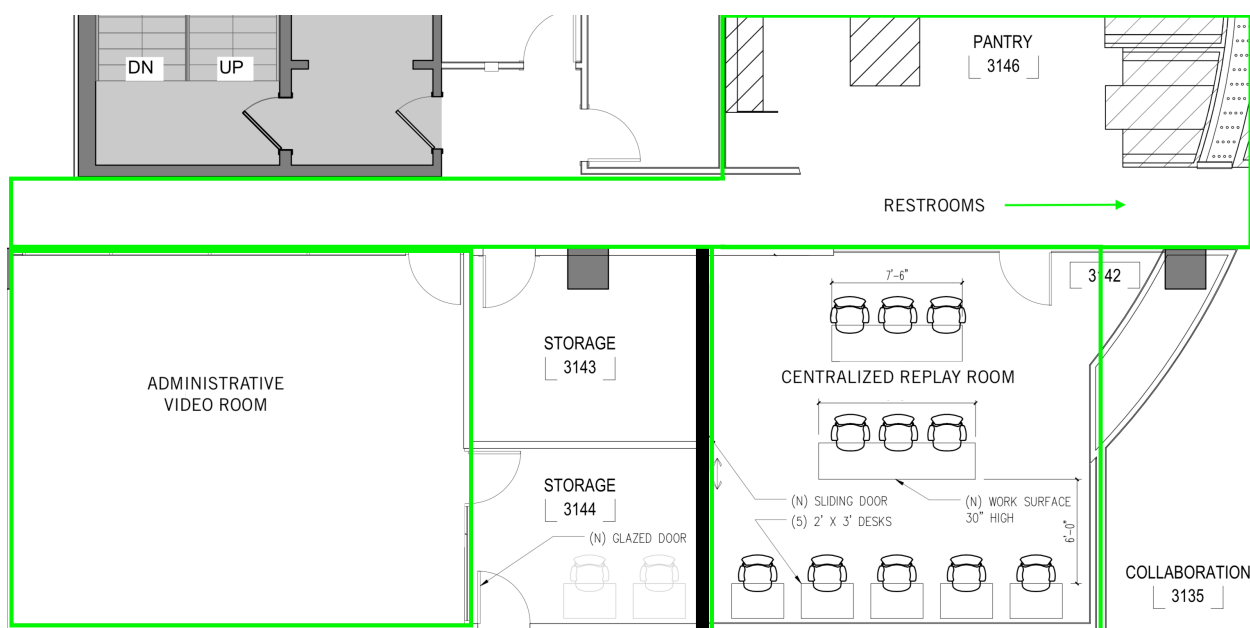

I. ADDITIONAL ITEMS.

CONFIDENTIALITY. All conversations and discussions in the Centralized Replay Room are to remain confidential and all Centralized Replay Room personnel shall at all times adhere to the terms of the confidentiality clauses in their employment agreements or independent contractor agreements. Social media posts or any other dissemination pertaining to conversations or situations that occur in the Centralized Replay Room, Video Administrative Room or Pac-12 offices, including posting videos or pictures of facilities and/or operations, are strictly prohibited.

CELL PHONES. The use of cell phones and personal electronics are not allowed in the Centralized Replay Room or at any point while personnel are working a live game.

VISITORS. Non-working personnel shall not be permitted into the Centralized Replay Room at any time unless previously approved by the Vice President of Officiating, Supervisor of Replay Officials and/or the Director of Video Operations. Non-working personnel shall be permitted entry into the Centralized Replay Room only for training and development purposes.

DRESS CODE. Centralized Replay Room personnel shall not wear team logo apparel.

MEALS. Meals will be provided for Centralized Replay Room working personnel.

PERSONAL CONVERSATIONS. Personal conversations should be kept to a minimum.

CHEERING. No cheering of any kind will be tolerated in the Centralized Replay Room.

EMERGENCY EXIT. The nearest emergency exit is located directly south of the Administrative Video Room (see diagram below).

